



DEPARTMENT OF THE ARMY
HEADQUARTERS III CORPS AND FORT HOOD
DIRECTORATE OF ENGINEERING
FORT HOOD, TEXAS 76544

IN REPLY REFER TO

27 SEP 1968

AKPHO-DOE-AD

SUBJECT: Excess Report, NIKE Hercules Site D-FW-20, Terrell, Texas

Commanding General
Fourth United States Army
Fort Sam Houston, Texas 78234

1. Reference DA Message 877001 from DCSLOG/IM-RPS, dated 24 August 1968.
2. Recommend NIKE Hercules Defense Site D-FW-20, Terrell, Texas be placed in excess status. In accordance with the provisions of AR 405-90, changes 1, 2 and 3, report of excess is furnished hereon.
 - a. Location - Kauffman County, Terrell, Texas
 - b. Acreage and identification of property - The installation consists of 24.15 acres of fee owned land and 77.84 acres of land held by easement. Metes and bounds description are not available at this installation.
 - c. Map or plot plan - see inclosure 2
 - d. Description of Improvements -
 - (1) Building 29 - Interconnecting Corridor
Size: 22' X 12'8" (1 story)
7'4" X 6' (2)
Foundation: Concrete
Floor: Concrete
Walls: Masonry Units
Roof: Built-up
Condition: Good
 - (2) Building 35 - ABAR Building
Size: 50'2 1/2" X 20'3 1/4" (1 story)
Foundation: Concrete
Floor: Concrete
Walls: Galvanized Steel
Roof: Galvanized Steel
Condition: Good

incl 3

AKPHO--DOE--AD

SUBJECT: Excess Report, NIKE Hercules Site D-FW-20, Terrell, Texas

- (3) Building 13 - Warheading Building
Size: 39'4" X 20' (1 story)
Foundation: Concrete
Floor: Concrete
Walls: Masonry Units
Roof: Built-up
Condition: Good

- (4) Building 10 - Underground Missile Storage Structure Type "D"
Size: 70' X 64'6"
43' X 13'
19'6" X 20'6"
21' X 4"
37'10" X 5'
Foundation, floors, walls & roof - concrete
Condition: Good

- (5) Building 11 - Underground Missile Storage Structure Type "D"
Size: 70' X 64'6"
43' X 13'
19'6" X 20'6"
21' X 4'
37'10" X 5'
Foundation, floors, walls & roof - concrete
Condition: Good

- (6) Building 12 - Underground Missile Storage Structure Type "D"
Size: 70' X 64'6"
43' X 13'
19'6" X 20'6"
21' X 4'
37'10" X 5'
Foundation, floors, walls & roof - concrete
Condition: Good

- (7) Building 2 - Ready Building
Size: 55' X 32'4" (1 story)
Foundation: Concrete
Floors: Concrete
Walls: Masonry Units
Roof: Built-up
Condition: Good

- (8) Building #34 - Antenna Tower
Structural steel, 16'10" high on concrete foundation
Condition: Good

AKPHO-DOE-AD

SUBJECT: Excess Report, NIKE Hercules Site D-FW-20, Terrell, Texas

- (9) Building #30 - FUIF Pad
Concrete , 7' X 7'; 9' X 16'
Condition: Good

- (10) Building #33 - Base for Bore Site Mast
Concrete - 2' X 2'
Condition: Good

- (11) Building #37 - Target Ranging Radar Pad
Concrete - circular shape
Condition: Good

- (12) Building #31 - Lightning Mast
Condition: Good

- (13) Building #32 - Lightning Mast
Condition: Good

- (14) Building 3 - Missile Assembly & Test Building
Size: 40' X 39'4"
Foundation: Concrete
Floors: Concrete
Walls: Masonry Units
Roof: Built-up
Condition: Good

- (15) Building 8 - Acid Storage Shed
Size: 6'6" X 6'6"
Foundation: Concrete
Floor: Concrete
Walls: Corrugated Metal
Roof: Corrugated Metal
Condition: Good

- (16) Building 26 - Paint & Oil Storage
Size: 7'4" X 7'4"
Foundation: Concrete
Floor: Concrete
Walls: Masonry Units
Roof: Built-up
Condition: Good

AKPHO-DOE-AD

SUBJECT: Excess Report, NIKE Hercules Site D-FW-20, Terrell, Texas

- (17) Building 15 - Miscellaneous Storage
Size: 12' X 12'
Foundation: Concrete
Floor: Concrete
Walls: Metal
Roof: Metal
Condition: Good

- (18) Building 36 - Miscellaneous Storage
Size: 21' X 24'
Foundation: Concrete
Floor: Concrete
Walls: Metal
Roof: Metal
Condition: Good

- (19) 430 Sq Yd Asphalt Open Storage Area
Condition: Good

- (20) Building 25 - Admin, Rec & Storage
Size: 125'4" X 32'4"
9'4" X 10'
Foundation: Concrete
Floor: Concrete
Walls: Masonry Units
Roof: Built-up
Condition: Good

- (21) Building #24 - Flagpole
35' Steel
Condition: Good

- (22) Building 21 - EM Barracks W/O Mess
Size: 32'4" X 127'4"
6' X 12'10"
35'6" X 77'
Foundation: Concrete
Floors: Concrete
Walls: Masonry Units
Roof: Built-up
Condition: Good

AKPHO-DOE-AD

SUBJECT: Excess Report, NIKE Hercules Site D-FW-20, Terrell, Texas

- (23) Building 22 - EM Barracks W/O Mess
Size: 32'4" X 114' (1 story)
6' X 12'10"
35'6" X 46'
Foundation: Concrete
Floor: Concrete
Walls: Masonry Units
Roof: Built-up
Condition: Good
- (24) Building 23 - Mess Hall
Size 84'6" X 30' (1 story)
5'8" X 6'8" (3)
11'4" X 12'4"
Foundation: Concrete
Floor: Concrete
Walls: Masonry Unit
Roof: Built-up
Condition: Good
- (25) Building 6 - Generator Building
Size: 41' X 20' (1 story)
Foundation: Concrete
Floor: Concrete
Walls: Masonry Units
Roof: Built-up
Condition: Good
- (26) Building 28 - Engine Generator and Frequency Changer Building
Size: 29' X 25'4" (1 story)
6'8" X 13'4"
Foundation: Concrete
Floor: Concrete
Walls: Masonry Units
Roof: Built-up
Condition: Good
- (27) 11,190 ft Electric Distribution Lines
Condition: Good
- (28) 7,511 Lin ft Gas Lines
Condition: Good
- (29) 4,466 Lin ft Sewer Lines
Condition: Good

AKPHO-DOE-AD

SUBJECT: Excess Report, NIKE Hercules Site D-FW-20, Terrell, Texas

- (30) Building #4 - Water Storage Tank
4,200 gal, steel on conc pad
Condition: Good
- (31) 12,500 Lin Ft Water Distribution Lines
Condition: Good
- (32) Building 5 - Booster Pump Station
Size: 13'4" X 11'4"
Foundation: Concrete
Floor: Concrete
Walls: Masonry Units
Roof: Built-up
Condition: Good
- (33) 8,098 Sq Yd Asphalt Roads
Condition: Good
- (34) 19,823 Sq Yd Asphalt Parking Area
Condition: Good
- (35) 2,079 Sq Yd Concrete Walks
Condition: Good
- (36) 3,251 Sq Yd Concrete Other Pavement
Condition: Good
- (37) 1,222 Lin Ft Storm Sewer
Condition: Good
- (38) Landscaping
- (39) 7,899 Lin Ft Chain Link Fence
Condition: Good
- (40) Building 1 - Sentry Station
Size: 7' X 5'
Foundation: Concrete
Floor: Concrete
Walls: Masonry Units
Roof: Built-up
Condition: Good

AKPHO-DOE-AD

SUBJECT: Excess Report, NIKE Hercules Site D-FW-20, Terrell, Texas

- (41) Building 9 - Sentry Control Station
Size: 11'2½" X 8'1½" (1 story)
Foundation: Concrete
Floor: Concrete
Walls: Wood
Roof: Built-up
Condition: Good
 - (42) Building 20 - Sentry Station
Size: 7'4" X 5'4" (1 story)
Foundation: Concrete
Floor: Concrete
Walls: Masonry Units
Roof: Built-up
Condition: Good
 - (43) Building 7 - Kennel
Size: 14'5" X 22' (1 story)
Foundation: Concrete
Floor: Concrete
Walls: Plywood & Chain Link Fence
Condition: Good
 - (44) Anti Intrusion System (Central Alarm)
Condition: Good
 - (45) Building #14 - Acid Fueling Station
Concrete
Condition: Good
 - (46) Land, Fee Owned - 24.15 acres
 - (47) Land - Temporary Permit
Tract A-105P (no area cited) from Texas Highway Department
 - (48) Land, Easement (Utility and restrictive) - 77.84 acres
- e. Purpose for which used - Air Defense Site for the Dallas-Fort Worth Defense Area. The present mission will be discontinued and will not be moved to another location.
- f. Reason for disposition - Decision of the Department of Defense.

AKPHO-DOE-AD

SUBJECT: Excess Report, NIKE Hercules Site D-FW-20, Terrell, Texas

- g. Interest held by the United States in the land - Fee owned.
- h. Date of availability for excess - 10 January 1969.
- i. There are no contractual commitments affecting disposition of this property.
- j. There are no auxiliary facilities affecting disposal of this property.
- k. There are no commitments to other Army Agencies, Military Departments or Federal Agencies which might affect disposition.
- l. This area has not been used for any purpose which might result in its being contaminated by live ammunition or explosives.
- m. There are no post or private cemeteries located within the area recommended for excess.
- n. The value of the property involved on this report is in excess of \$50,000.00 as indicated by inclosure 1.
- o. The annual operational cost and maintenance cost of this installation in a standby status is estimated to be \$30,200.00. Type and source of funds are unknown.
- p. There are 67 permanent employees working out of the USA Forward Area Support Shop, located at Fort Worth General Depot, who will lose their jobs as a result of the disposal of NIKE Sites D-FW-01, D-FW-20, D-FW-30 and D-FW-50. Their mission is to support the NIKE Sites in the Dallas-Fort Worth Defense Area.
- q. The area involved does not include any family housing.

FOR THE COMMANDER:

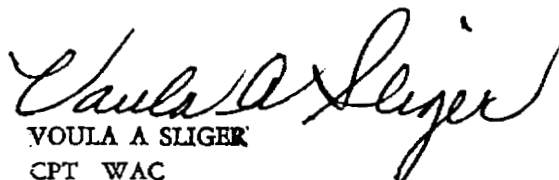
VOULA A SLIGER
CPT WAC
Act Asst AG

2 Incl

- 1. Cy Dist Engr Statement
- 2. Maps (trip)

Copy furnished:
Dist Engr, Ft Worth Dist, CE

STATE INDEX

ACQUISITION TRACT REGISTER

TRACT NO.	LAND ACQUISITION	ACQUISITION DATE	REMARKS
1
2
3
4
5
6
7
8
9
10
11
12
13
14
15
16
17
18
19
20
21
22
23
24
25
26
27
28
29
30
31
32
33
34
35
36
37
38
39
40
41
42
43
44
45
46
47
48
49
50
51
52
53
54
55
56
57
58
59
60
61
62
63
64
65
66
67
68
69
70
71
72
73
74
75
76
77
78
79
80
81
82
83
84
85
86
87
88
89
90
91
92
93
94
95
96
97
98
99
100

PROJECT MAP

LOCATION OF PROJECT

TRANSPORTATION FACILITIES

ACQUISITION

DISPOSAL

LEGEND

AUDITED

OFFICE OF THE PORT ENGINEER, DIVISION OF NAVIGATION, U.S. NAVY

DALLAS-FORT WORTH DEFENSE AREA

MIKE BATTERY RD, TEXAS

ACQUISITION AUTHORITY

U.S. GOVERNMENT PRINTING OFFICE: 1964 O 4772

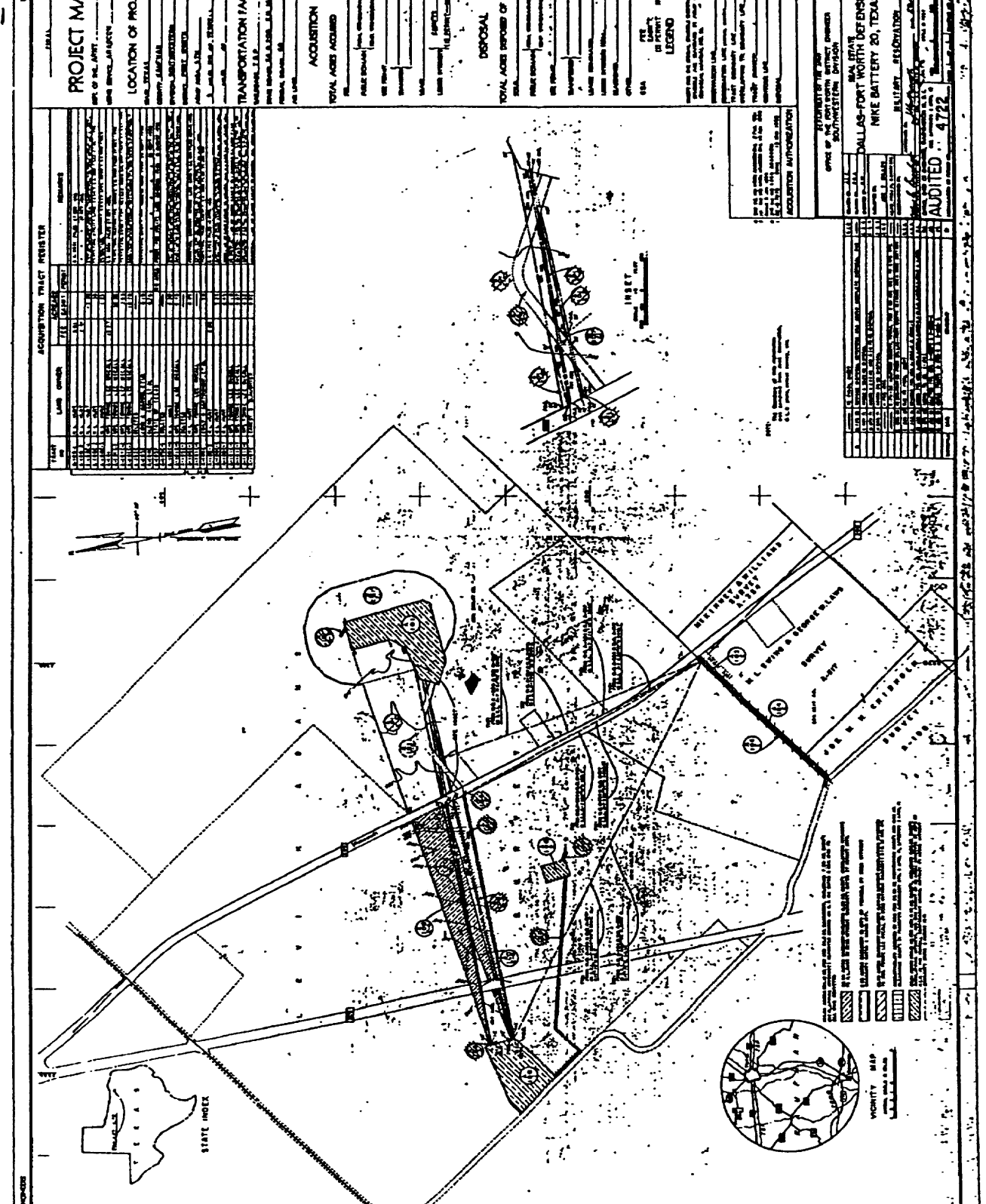

CORPS OF ENGINEERS

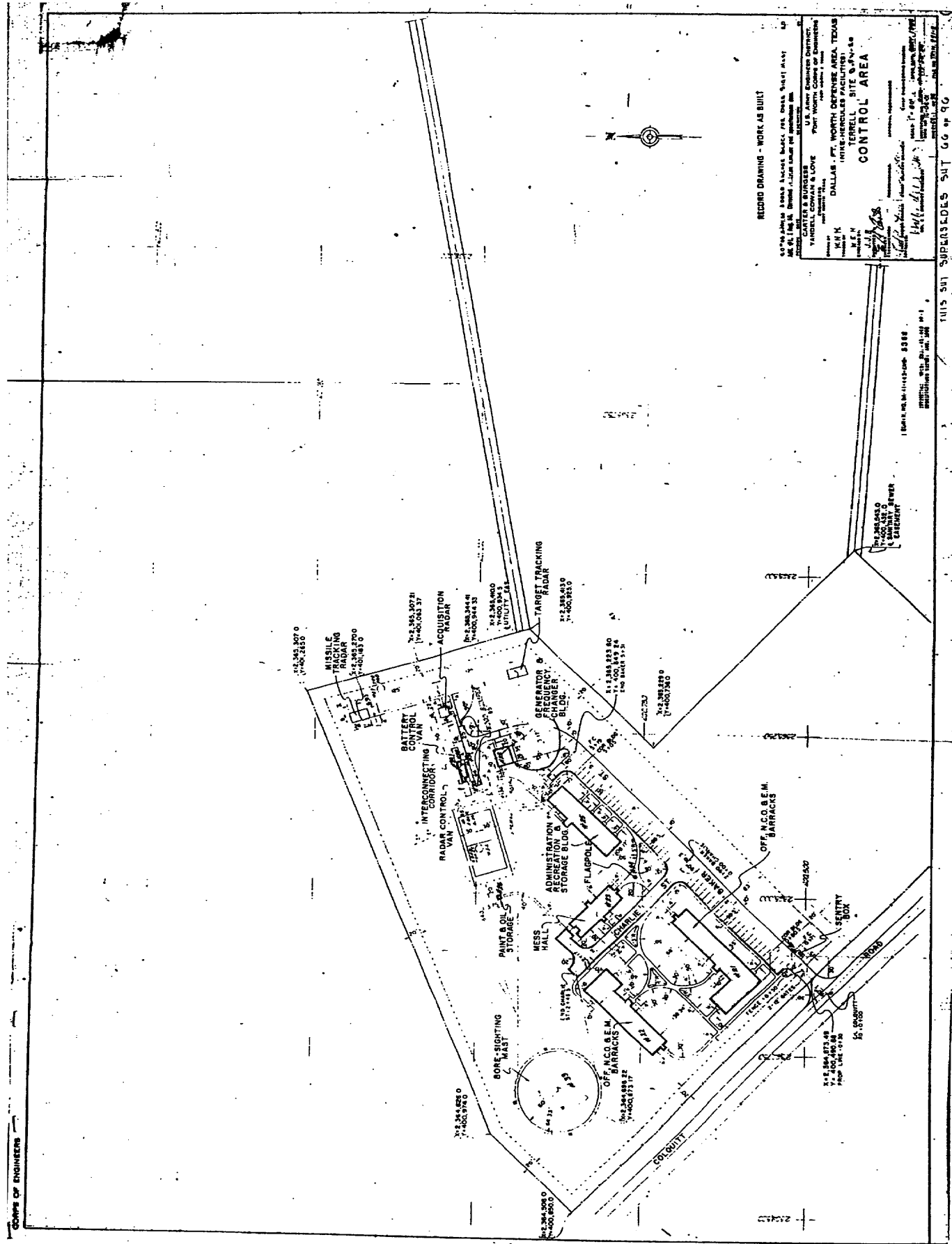

RECORD DRAWING - WORK AS BUILT

APPROVED: [Signature]

DATE: [Signature]

U.S. Army Engineers District
FORT MONROE, VIRGINIA

DALLAS, FT. WORTH DEFENSE AREA, TEXAS
TERRELL - SITE 5, 7, 11-13
CONTROL AREA

DESIGNED BY: [Signature]

SCALE: AS SHOWN

1: [Signature]

2: [Signature]

3: [Signature]

4: [Signature]

5: [Signature]

6: [Signature]

7: [Signature]

8: [Signature]

9: [Signature]

10: [Signature]

11: [Signature]

12: [Signature]

13: [Signature]

14: [Signature]

15: [Signature]

16: [Signature]

17: [Signature]

18: [Signature]

19: [Signature]

20: [Signature]

21: [Signature]

22: [Signature]

23: [Signature]

24: [Signature]

25: [Signature]

26: [Signature]

27: [Signature]

28: [Signature]

29: [Signature]

30: [Signature]

31: [Signature]

32: [Signature]

33: [Signature]

34: [Signature]

35: [Signature]

36: [Signature]

37: [Signature]

38: [Signature]

39: [Signature]

40: [Signature]

41: [Signature]

42: [Signature]

43: [Signature]

44: [Signature]

45: [Signature]

46: [Signature]

47: [Signature]

48: [Signature]

49: [Signature]

50: [Signature]

51: [Signature]

52: [Signature]

53: [Signature]

54: [Signature]

55: [Signature]

56: [Signature]

57: [Signature]

58: [Signature]

59: [Signature]

60: [Signature]

61: [Signature]

62: [Signature]

63: [Signature]

64: [Signature]

65: [Signature]

66: [Signature]

67: [Signature]

68: [Signature]

69: [Signature]

70: [Signature]

71: [Signature]

72: [Signature]

73: [Signature]

74: [Signature]

75: [Signature]

76: [Signature]

77: [Signature]

78: [Signature]

79: [Signature]

80: [Signature]

81: [Signature]

82: [Signature]

83: [Signature]

84: [Signature]

85: [Signature]

86: [Signature]

87: [Signature]

88: [Signature]

89: [Signature]

90: [Signature]

91: [Signature]

92: [Signature]

93: [Signature]

94: [Signature]

95: [Signature]

96: [Signature]

97: [Signature]

98: [Signature]

99: [Signature]

100: [Signature]

1. 1964-65. No. 11-10-10-60-68 0008
 PREPARED BY: [Signature]
 CHECKED BY: [Signature]
 DATE: [Signature]

TUHS SHI SUPERSEDES SHI 06 99 90

U.S. ARMY

CORPS OF ENGINEERS

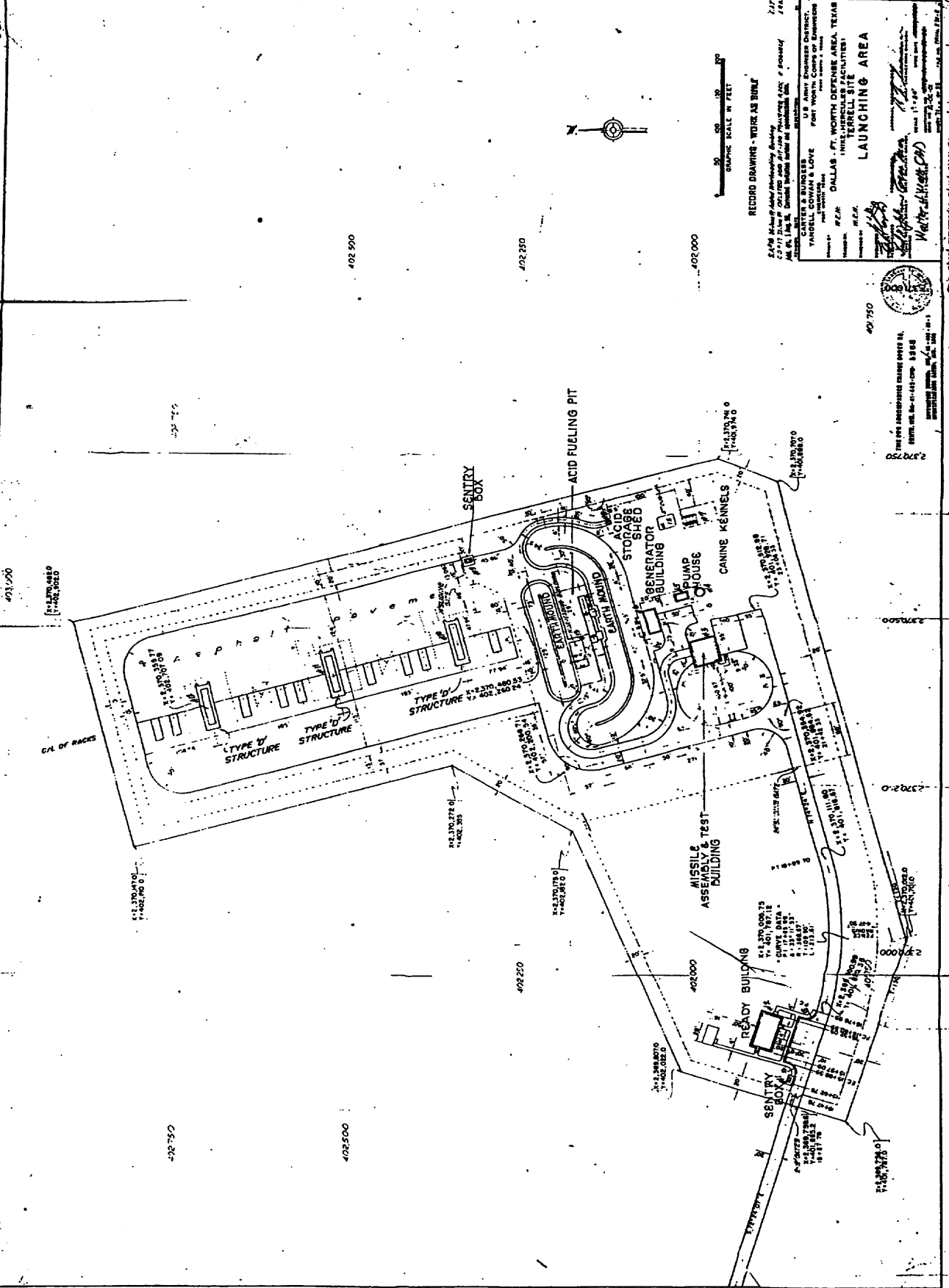

RECORD DRAWING - WORK AS SHOWN

Checked by: [Signature]
 Drawn by: [Signature]

DESIGNER:
 VANDELL COWAN & LOVE
 1001 NORTH COMPTON ST.
 DALLAS, TEXAS

PROJECT:
 WORTH DEFENSE AREA, TEXAS
 MISSILE LAUNCHING FACILITIES

DATE: 11-1-58

SCALE: AS SHOWN

LAUNCHING AREA

2,579,250
 2,579,500
 2,579,750

401,500
 402,000
 402,500
 403,000